

THE 66th TORONTO INTERNATIONAL BOAT SHOW  
 January 19 -28, 2024  
 ENERCARE CENTRE

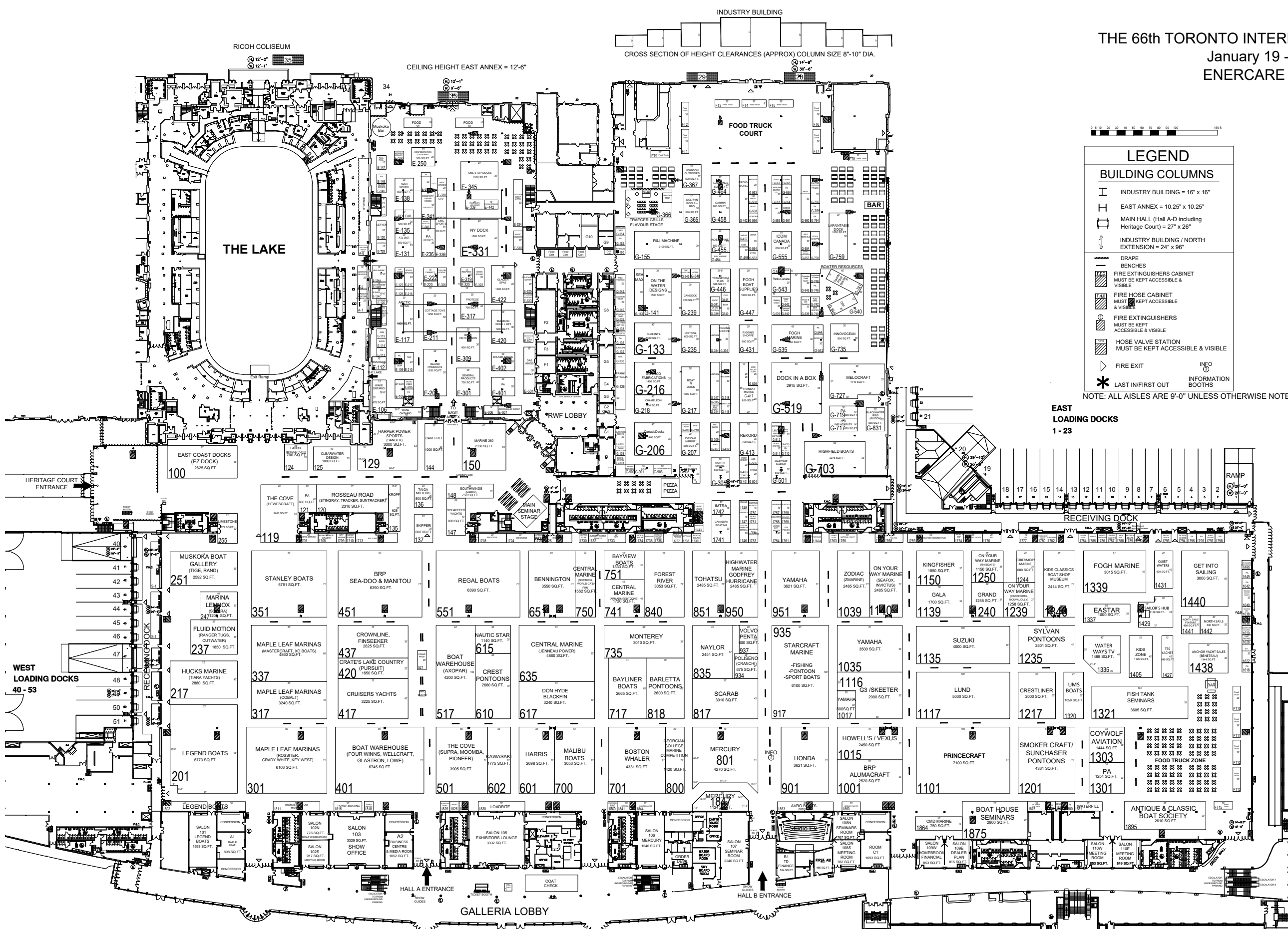

### LEGEND

#### BUILDING COLUMNS

- I INDUSTRY BUILDING = 16" x 16"
- H EAST ANNEX = 10.25" x 10.25"
- MAIN HALL (Hall A-D including Heritage Court) = 27" x 26"
- INDUSTRY BUILDING / NORTH EXTENSION = 24" x 96"

- DRAPE
- BENCHES
- ☒ FIRE EXTINGUISHERS CABINET MUST BE KEPT ACCESSIBLE & VISIBLE
- ☒ FIRE HOSE CABINET MUST BE KEPT ACCESSIBLE & VISIBLE
- ⊙ FIRE EXTINGUISHERS MUST BE KEPT ACCESSIBLE & VISIBLE
- ☒ HOSE VALVE STATION MUST BE KEPT ACCESSIBLE & VISIBLE
- △ FIRE EXIT
- ⊙ INFO INFORMATION BOOTHS
- \* LAST IN/FIRST OUT

NOTE: ALL AISLES ARE 9'-0" UNLESS OTHERWISE NOTED.

EAST LOADING DOCKS  
 1 - 23

RECEIVING DOCK

WEST LOADING DOCKS  
 40 - 53

CEILING HEIGHT MAIN HALL(A-D) = 47', 55', 47'

PRINCES' BOULEVARD